

## SECTION 9.415 DOWNTOWN RESIDENTIAL DETACHED (DRD)

### (a) DRD Building Standards.

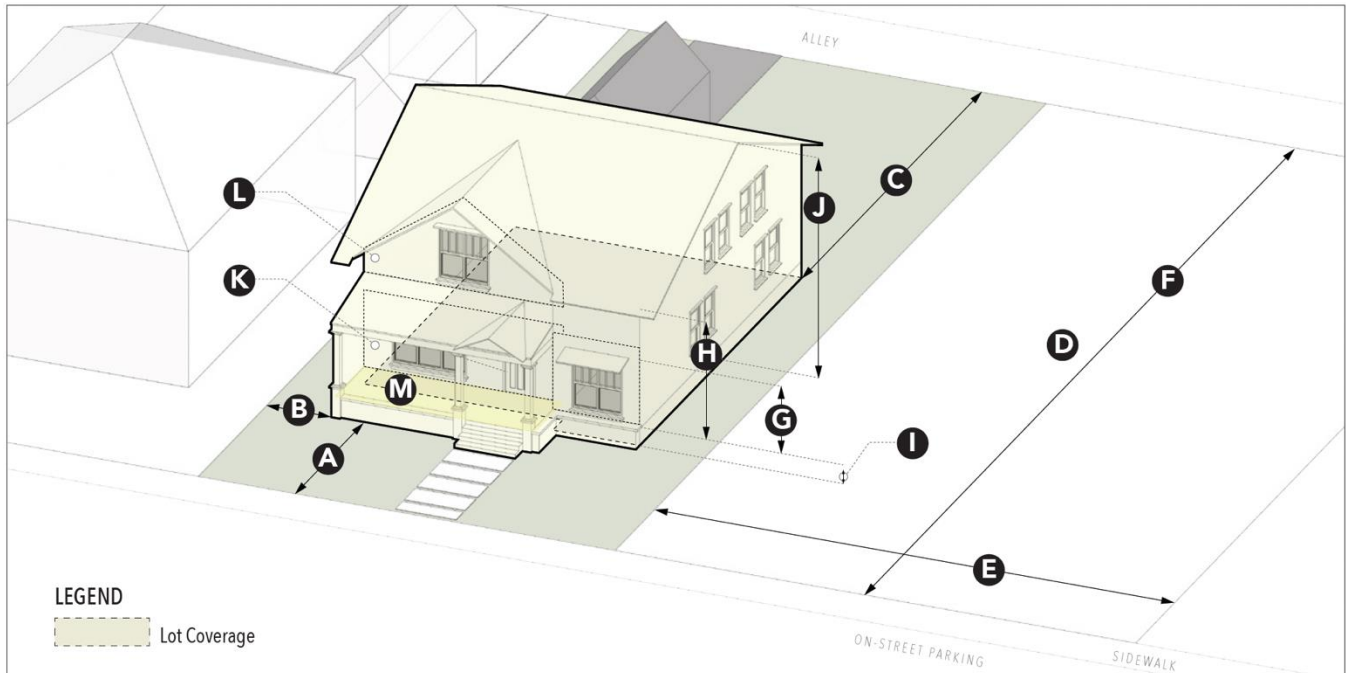

Use (see Note 1)		
Ground/upper floor:	residential, commercial (retail, service, office)	
Placement		
Front setback	10 ft min., 30 ft max.	A
Side setback	5 ft min.	B
Rear setback	5 ft min.; 0 ft min. when abutting an alley	C
Coverage		
Lot area	4,000 sf min.	D
Lot width	30 ft min.; 40 ft min. for corner lots	E
Lot depth	60 ft min.	F
Lot coverage	50% max., 60% max. with Accessory Dwelling Unit (ADU); see Note 3	
Height		
Minimum number of floors	1 floors	G
Maximum number of floors	3 floors	H
Ground floor elevation	18 in min. above sidewalk (recommend, but not required).	I
Building height	subject to Fire Chief approval.; see Note 4	J
Facade Transparency		
Ground floor	40% of facade area min.	K
Upper floors	40% of facade area min.	L
Porch / covered stoop		
Dimension	6 x 6 ft min. for each primary entry	M
Parking		
Number of required space	1 space per unit; see Note 5	

### Notes

- Uses that create odor, dust, smoke, noise, or vibration that is perceptible beyond the property boundaries are prohibited.
- Primary building entrance must be located along the Required Pedestrian Entry Zone and oriented to the street.
- Maximum lot coverage includes accessory buildings, provided that any patio structure used solely for open space and swimming pool not structurally covered shall not be counted as a structure for ascertaining coverage.
- Maximum building height excludes basements and daylight basements. Accessory buildings are limited to one story.
- Off-street parking, drives, garages, and other vehicle areas must be oriented to and accessed from an alley, or located behind or to the side of the building; they shall not be placed between buildings and streets.
  - Attached and detached garages shall be oriented to and accessed from an alley
  - When no alley exists, garages shall be tucked under the first story and accessed from the front or side of the property if set back a minimum of 20 ft from the front or 10 ft from the side.
- Residential uses entirely above the ground floor must have a balcony at least four feet deep.